

TUDOR HERITAGE ADVISOR

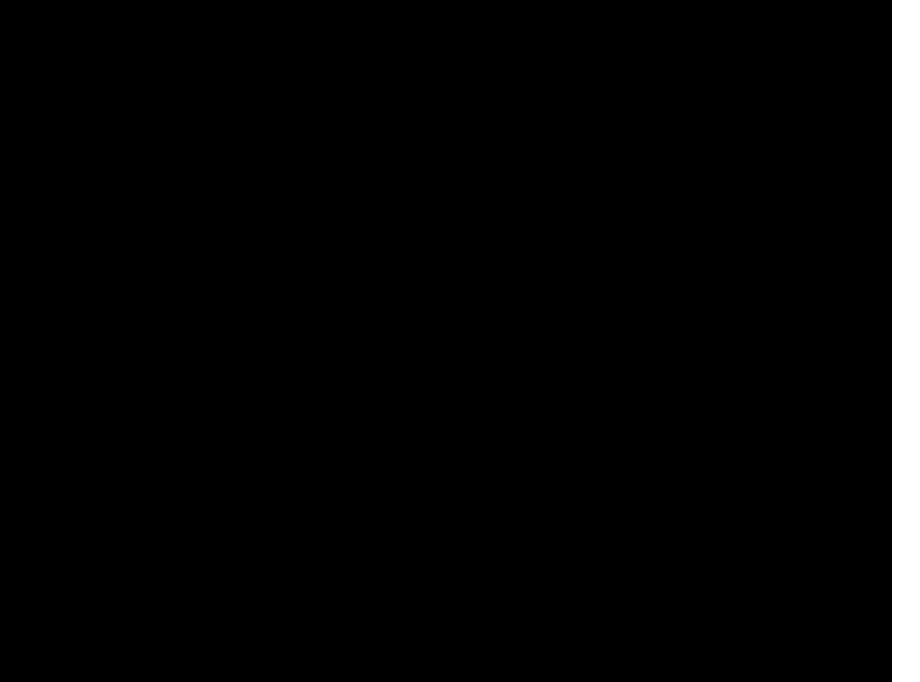

TUDOR







TUDOR

TUDOR HERITAGE ADVISOR

CONTENTS

GENERAL INFORMATION	5
WATERPROOFNESS	7
ADVISOR	8
MAINTENANCE & GUARANTEE	20
WORLDWIDE SERVICE NETWORK	22





All TUDOR models bear the Swiss Made quality label.

They are equipped with a self-winding mechanical movement, and feature a synthetic sapphire crystal and a winding crown, to ensure perfect waterproofness.

To ensure that your TUDOR watch remains in perfect working order for many years, please read this document carefully.





TUDOR HERITAGE	50 m	100 m	150 m	200 m	500 m
ADVISOR					
	165 ft	330 ft	500 ft	660 ft	1,640 ft



DISPLAY

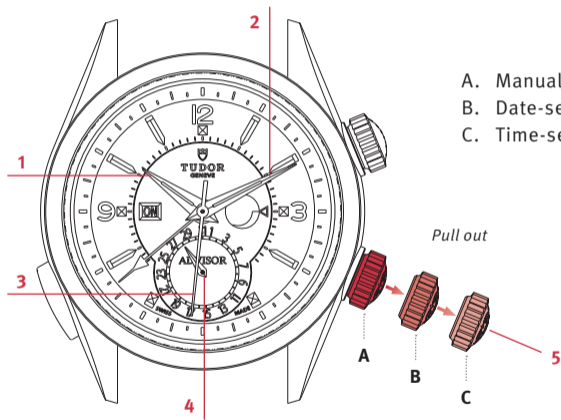

- A. Manual winding
- B. Date-setting
- C. Time-setting



Ø 42 mm, TUDOR calibre 2892 with additional mechanism for the alarm function, waterproof to 100 metres (330 ft).

Date (pointer-type display), alarm power reserve.

Key

1. Hour hand
2. Minute hand
3. Seconds hand
4. Date counter
5. Winding crown



MANUAL WINDING [position A]

A watch equipped with a self-winding mechanical movement is wound automatically by wrist movements alone. To ensure optimum winding, wear your watch daily.

Before you first use the watch or if it has stopped, you will need to wind it manually by turning the crown clockwise; the other direction is inactive.

Once wound, and without being worn, the Tudor Heritage Advisor has a power reserve of approximately 42 hours.

**DATE-SETTING [position B]**

In order to adjust the date, pull the crown out to the first notch. Then turn it anticlockwise until the desired date appears in the window. The date is adjusted when the hands pass midnight. During this operation, your watch will keep running.

You are advised not to correct the date between 20:00 and 02:00. If the date is corrected between these times, the date will not change at midnight, but 24 hours later.



TIME-SETTING [position C]

In order to adjust the time, pull the crown out to the last notch. Then turn it in either direction until the hands indicate the correct time. The seconds hand is stopped during this operation. To synchronize the seconds hand and minute hand, the fine adjustment must be performed in an anticlockwise direction.

If the watch has stopped, take care not to confuse midday and midnight during this operation. Move the hands forward to 12 o'clock; if the date changes, then it is midnight.



In a time-setting operation, the hour hand drags the alarm hand anticlockwise when they are superposed.

After each operation, remember to push the crown back in carefully against the case, in order to preserve your watch's waterproofness.



ALARM DISPLAY

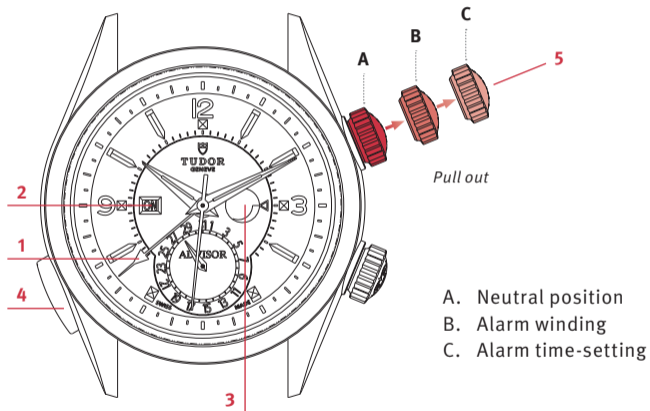



Key

1. Alarm hand
2. ON/OFF indicator for the alarm function
3. Alarm power-reserve indicator (here in full position)
4. Alarm function activating/deactivating pusher
5. Alarm-setting crown



ALARM WINDING [position B]

Before activating the alarm, you will need to wind it manually by pulling out the alarm-setting crown at the first notch. Then turn it clockwise. It is important not to overwind the crown.

Once the mechanism is fully wound, the alarm power-reserve indicator is at the maximum level which corresponds to an approximately 10-second ring.



ALARM TIME-SETTING [position C]

In order to adjust the alarm time, pull out the alarm-setting mechanism to the last notch. Then turn it clockwise until the alarm hand indicates the desired time.

ACTIVATION AND DEACTIVATION OF THE ALARM [position D]

The alarm is activated or deactivated by simply pressing the alarm activating/deactivating pusher. Its status is indicated by the ON/OFF mention at 9 o'clock.

After each operation, remember to push the crown back in carefully against the case, in order to preserve your watch's waterproofness.



ADJUSTING THE FABRIC STRAP

The Tudor Heritage Advisor model comes with an additional fabric strap. The length of the fabric strap can be adjusted by sliding it through the buckle and loops.

Only TUDOR Official Retailers are authorized to change the watch strap.



Shortening the strap

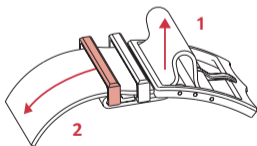
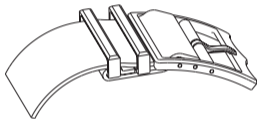

Lengthening the strap

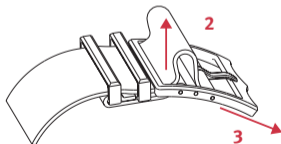
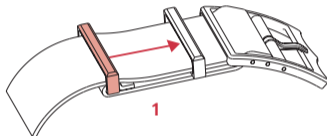



Thanks to TUDOR's expertise, your watch will require very little day-to-day care.

However, you can maintain the shine on your watch and its metal bracelet by using a microfibre cloth. You can also wash it from time to time, using a soft brush and soapy water.

Before performing these operations, check that the crown is properly pushed back in against the case, in order to guarantee your watch's waterproofness.

To help conserve your leather or fabric strap, we recommend protecting it from water and moisture.



Your TUDOR watch is covered by a 2-year international guarantee.

The guarantee card that accompanies your watch must be properly completed, signed and dated by the Official TUDOR Retailer at the time of purchase.

The guarantee does not cover normal wear of components, or damage caused by accident or mishandling, or the loss or theft of your watch.

Any modification of your watch by the addition of non-original parts, or the substitution of parts with non-original parts, will void your guarantee.



TUDOR watches are sold only by Official TUDOR Retailers.

Each TUDOR watch is a complex precision mechanism and, as such, requires periodic servicing and maintenance to guarantee optimum performance.

Expert TUDOR servicing can be carried out via any of the Official Retailers and Service Centres in the extensive ROLEX or TUDOR service network. This worldwide network spans five continents and is staffed by highly skilled watchmakers trained to respond to all your service needs.

Please contact your ROLEX Affiliate for an up-to-date list of TUDOR Official Retailers and Service Centres for your region.

TUDORWATCH.COM



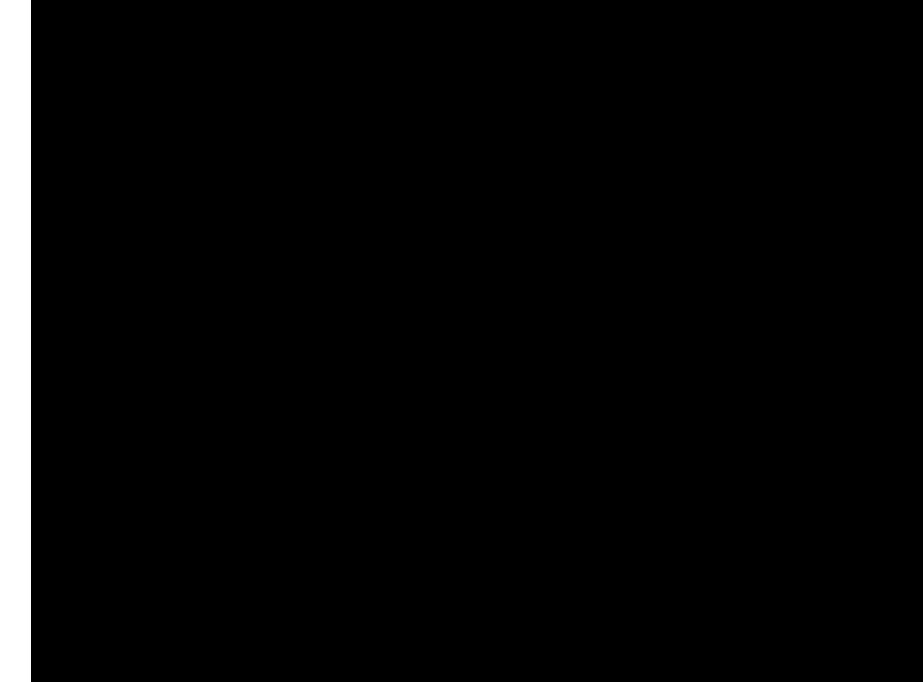



TUDOR

TUDORWATCH.COM

