



TUDOR HERITAGE RANGER



TUDOR







TUDOR

TUDOR HERITAGE RANGER

CONTENTS

GENERAL INFORMATION	5
WATERPROOFNESS	7
RANGER	8
MAINTENANCE & GUARANTEE	16
WORLDWIDE SERVICE NETWORK	18





All TUDOR models bear the Swiss Made quality label.

They are equipped with a self-winding mechanical movement, and feature a synthetic sapphire crystal and a screw-down winding crown to ensure perfect waterproofness.

To ensure that your TUDOR watch remains in perfect working order for many years, please read this document carefully.





TUDOR HERITAGE	50 m	100 m	150 m	200 m	500 m
RANGER					
	165 ft	330 ft	500 ft	660 ft	1,640 ft



DISPLAY

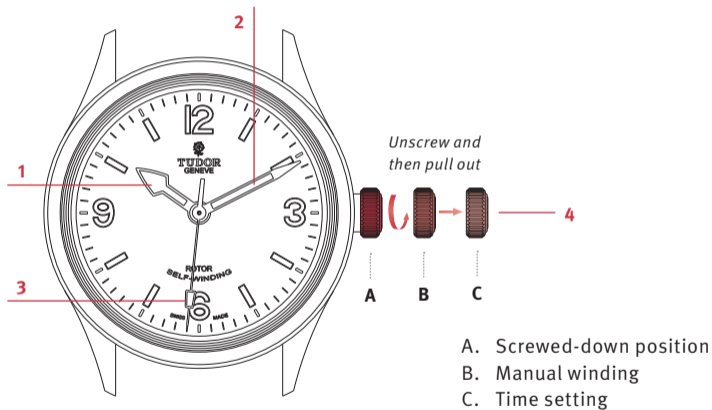



Ø 41 mm, TUDOR calibre 2824, waterproof to 150 metres.

Key

1. Hour hand
2. Minute hand
3. Seconds hand
4. Winding crown



SCREWED-DOWN POSITION (position A)

Your TUDOR watch is equipped with a screw-down crown. Once this is fully screwed down against the case, your watch is guaranteed waterproof.

MANUAL WINDING (position B)

A watch equipped with a self-winding mechanical movement is wound automatically by wrist movements alone. To ensure optimum winding, wear your watch daily.



Before you first use the watch or if it has stopped, you will need to wind it manually by unscrewing the crown and then turning it clockwise; the other direction is inactive. After performing the operation, gently press in the crown while turning it gradually clockwise, and screw it down carefully against the case in order to preserve your watch's waterproofness.

Once wound, and without being worn, the Tudor Heritage Ranger has a power reserve of approximately 38 hours.



TIME SETTING (position C)

In order to adjust the time, unscrew the crown and pull it out to the last notch. Then turn it in either direction until the hands indicate the correct time. The seconds hand is stopped during this operation, allowing the time to be set accurately.

After each operation, remember to push the crown back in and screw it back down carefully against the case, in order to preserve your watch's waterproofness.



ADJUSTING THE FABRIC STRAP

The Tudor Heritage Ranger model comes with an additional fabric strap. The length of the fabric strap can be adjusted by sliding it through the buckle and loops.

Only Official TUDOR Retailers are authorized to change the watch strap.



Shortening the strap

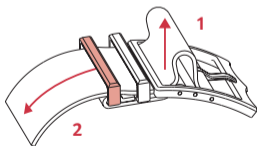
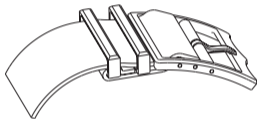

Lengthening the strap

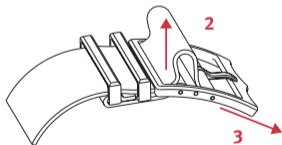
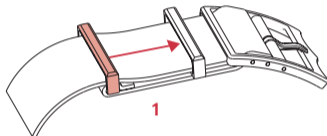



Thanks to TUDOR's expertise, your watch will require very little day-to-day care.

However, you can maintain the shine on your watch and its metal bracelet by using a microfibre cloth. You can also wash it from time to time using a soft brush and soapy water.

Before performing these operations, check that the crown is properly screwed down against the case, in order to guarantee your watch's waterproofness.

To help preserve your leather or fabric strap, we recommend protecting it from water and moisture.



Your TUDOR watch is covered by a 2-year international guarantee.

The guarantee card that accompanies your watch must be properly completed, signed and dated by the Official TUDOR Retailer at the time of purchase.

The guarantee does not cover normal wear of components, or damage caused by accident or mishandling, or the loss or theft of your watch.

Any modification of your watch by the addition of non-original parts, or the substitution of parts with non-original parts, will void your guarantee.



TUDOR watches are sold only by Official TUDOR Retailers.

Each TUDOR watch is a complex precision mechanism and, as such, requires periodic servicing and maintenance to guarantee optimum performance.

Expert TUDOR servicing can be carried out via any of the Official Retailers and Service Centres in the extensive ROLEX or TUDOR service network. This worldwide network spans five continents and is staffed by highly skilled watchmakers trained to respond to all your service needs.

Please contact your ROLEX Affiliate for an up-to-date list of TUDOR Official Retailers and Service Centres for your region.







TUDORWATCH.COM



TUDOR

© Montres TUDOR SA
Rue François-Dussaud 3-5-7
1211 Geneva 26, Switzerland
TUDORWATCH.COM

Trademarks:

TUDOR, TUDORWATCH,  TUDOR,  TUDOR,  TUDOR,  TUDOR, WATCH YOUR STYLE, AERONAUT,
BLACK BAY, BLACK SHIELD, CLAIR DE ROSE, GRANTOUR,
HYDRONAUT, ICONAUT, PELAGOS, TUDOR ADVISOR,
TUDOR FASTRIDER, TUDOR GLAMOUR, TUDOR HERITAGE,
TUDOR HERITAGE RANGER,   TUDOR PRINCE,
TUDOR PRINCESS.

585.72 EN – 6.2014







TUDOR

TUDORWATCH.COM

