

TUDOR CLAIR DE ROSE

TUDOR GLAMOUR

TUDOR CLASSIC



TUDOR







TUDOR

TUDOR CLAIR DE ROSE
TUDOR GLAMOUR
TUDOR CLASSIC

CONTENTS

| | |
|---------------------------|----|
| GENERAL INFORMATION | 5 |
| WATERPROOFNESS | 7 |
| BASIC FUNCTIONS | 10 |
| CLAIR DE ROSE | 16 |
| GLAMOUR DOUBLE DATE | 18 |
| GLAMOUR, CLASSIC DATE-DAY | 20 |
| GLAMOUR, CLASSIC DATE | 24 |
| MAINTENANCE & GUARANTEE | 26 |
| WORLDWIDE SERVICE NETWORK | 28 |





All TUDOR models bear the Swiss Made quality label.

They are equipped with a self-winding mechanical movement, and feature a synthetic sapphire crystal and a screw-down winding crown, to ensure perfect waterproofness.

To ensure that your TUDOR watch remains in perfect working order for many years, please read this document carefully.





TUDOR

WATERPROOFNESS

| | | | | | |
|---------------------|--------|--------|--------|--------|----------|
| TUDOR CLAIR DE ROSE | 50 m | 100 m | 150 m | 200 m | 500 m |
| CLAIR DE ROSE | | | | | |
| TUDOR GLAMOUR | 50 m | 100 m | 150 m | 200 m | 500 m |
| DOUBLE DATE | | | | | |
| DATE-DAY | | | | | |
| DATE | | | | | |
| | 165 ft | 330 ft | 500 ft | 660 ft | 1,640 ft |

WATERPROOFNESS

TUDOR



| TUDOR CLASSIC | 50 m | 100 m | 150 m | 200 m | 500 m |
|---------------|--------|--------|--------|--------|----------|
| DATE-DAY | | | | | |
| DATE | | | | | |
| | 165 ft | 330 ft | 500 ft | 660 ft | 1,640 ft |

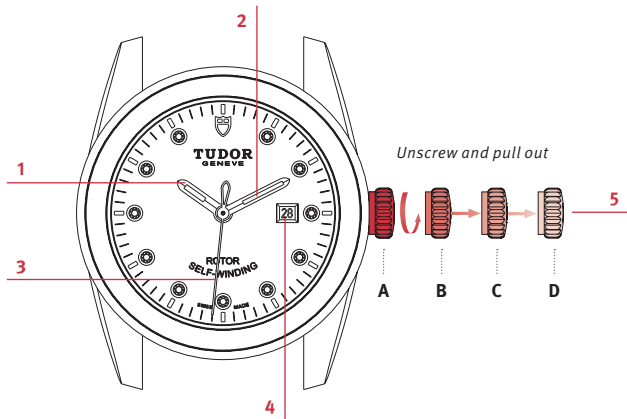



Key

1. Hour hand
2. Minute hand
3. Seconds hand
4. Date window
5. Winding crown

Winding crown

- A. Screwed-down position
- B. Manual winding
- C. Date-setting
- D. Time-setting

SCREWED-DOWN POSITION [position A]

Your TUDOR watch is equipped with a screw-down crown.

Once this is fully screwed down against the case, your watch is guaranteed waterproof.

MANUAL WINDING [position B]

A watch equipped with a self-winding mechanical movement is wound automatically by wrist movements alone. To ensure optimum winding, wear your watch daily.



Before you first use the watch or if it has stopped, you will need to wind it manually by unscrewing the crown and turning it clockwise; the other direction is inactive. After performing the operation, gently press in the crown while turning it gradually clockwise, and screw it down carefully against the case in order to preserve your watch's waterproofness.

Once wound, and without being worn, the Clair de Rose, Glamour and Classic models have a power reserve of approximately 38 hours. The Glamour Double Date has a power reserve of approximately 42 hours.



DATE-SETTING [position C]

In order to adjust the date, unscrew the crown and pull it out to the second notch. Then turn it clockwise, or anticlockwise on your Glamour Double Date, until the desired date appears in the window. The date is corrected when the hands pass midnight. During this operation, your watch will keep running.

You are advised not to correct the date between 20:00 and 02:00. If the date is corrected between these times, the date will not change at midnight, but 24 hours later.



TIME-SETTING [position D]

In order to adjust the time, unscrew the crown and pull it out to the last notch. Then turn it in either direction until the hands indicate the correct time. The seconds hand is stopped during this operation. To synchronize the seconds hand and minute hand, the fine adjustment must be performed in an anticlockwise direction.

If the watch has stopped, take care not to confuse midday and midnight during this operation. Move the hands forward to 12 o'clock; if the date changes, then it is midnight.

After each operation, remember to push the crown back in and screw it back down carefully against the case, in order to preserve your watch's waterproofness.

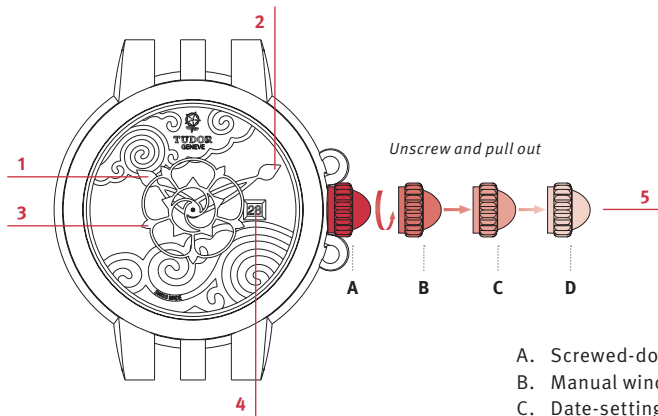

- A. Screwed-down position
- B. Manual winding
- C. Date-setting
- D. Time-setting



Ø 34 mm, TUDOR calibre 2824, waterproof to 100 metres (330 feet).

Ø 30 mm, Ø 26 mm, TUDOR calibre 2671, waterproof to 100 metres (330 feet).

Date (window-type display), crown guard, domed sapphire crystal.

Key

1. Hour hand
2. Minute hand
3. Centre seconds hand
4. Date window
5. Winding crown

For any other adjustments to your watch, refer to the “BASIC FUNCTIONS” section on page 10.

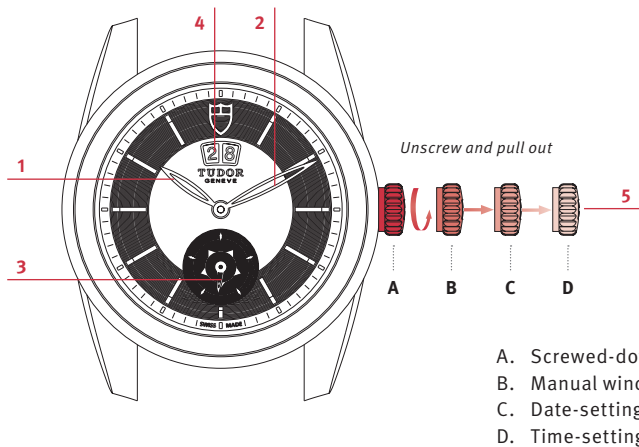



Ø42 mm, TUDOR calibre 2892 with additional mechanism for a double date display and a small seconds counter, waterproof to 100 metres (330 feet).

Date (double window-type display), small seconds hand, domed sapphire crystal.

Key

1. Hour hand
2. Minute hand
3. Small seconds hand
4. Date window
5. Winding crown

For any other adjustments to your watch, refer to the “BASIC FUNCTIONS” section on page 10.

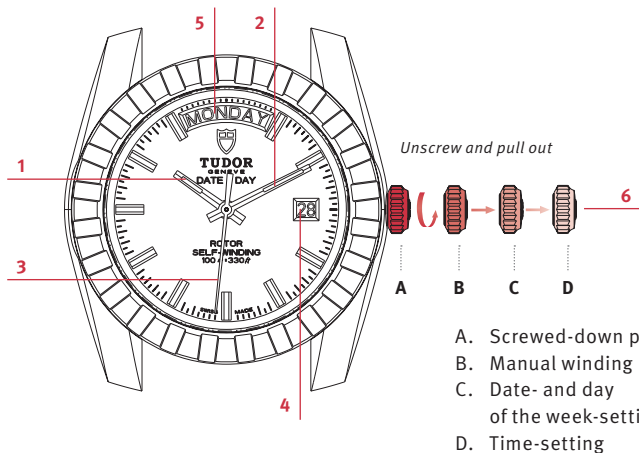



Ø 41 mm, Ø 39 mm, TUDOR calibre 2834, waterproof to 100 metres (330 feet).

Date (window-type display), day of the week function.

Key

1. Hour hand
2. Minute hand
3. Seconds hand
4. Date window
5. Day of the week window
6. Winding crown



DAY OF THE WEEK FUNCTION [position C]

In order to adjust the day of the week, unscrew and pull the crown out to the second notch. Then turn it anticlockwise until the desired day appears in the window.

After each operation, remember to push the crown back in and screw it back down carefully against the case, in order to preserve your watch's waterproofness.

For any other adjustments to your watch, refer to the “BASIC FUNCTIONS” section on page 10.

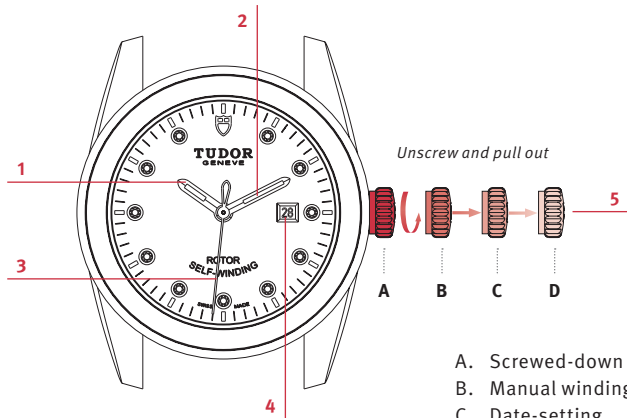

- A. Screwed-down position
- B. Manual winding
- C. Date-setting
- D. Time-setting



Ø 38 mm, Ø 36 mm, TUDOR calibre 2824, waterproof to 100 metres (330 feet).

Ø 31 mm, Ø 28 mm, Ø 26 mm, TUDOR calibre 2671, waterproof to 100 metres (330 feet).

Date (window-type display).

Key

1. Hour hand
2. Minute hand
3. Seconds hand
4. Date window
5. Winding crown

For any other adjustments to your watch, refer to the “BASIC FUNCTIONS” section on page 10.



Thanks to TUDOR's expertise, your watch will require very little day-to-day care.

However, you can maintain the shine on your watch and its metal bracelet by using a microfibre cloth. You can also wash it from time to time, using a soft brush and soapy water.

Before performing these operations, check that the crown is properly screwed down against the case, in order to guarantee your watch's waterproofness.

To help conserve your leather or fabric strap, we recommend protecting it from water and moisture.



Your TUDOR watch is covered by a 2-year international guarantee.

The guarantee card that accompanies your watch must be properly completed, signed and dated by the Official TUDOR Retailer at the time of purchase.

The guarantee does not cover normal wear of components, or damage caused by accident or mishandling, or the loss or theft of your watch.

Any modification of your watch by the addition of non-original parts, or the substitution of parts with non-original parts, will void your guarantee.



TUDOR watches are sold only by Official TUDOR Retailers.

Each TUDOR watch is a complex precision mechanism and, as such, requires periodic servicing and maintenance to guarantee optimum performance.

Expert TUDOR servicing can be carried out via any of the Official Retailers and Service Centres in the extensive ROLEX or TUDOR service network. This worldwide network spans five continents and is staffed by highly skilled watchmakers trained to respond to all your service needs.

Please contact your ROLEX Affiliate for an up-to-date list of TUDOR Official Retailers and Service Centres for your region.

TUDORWATCH.COM







TUDOR

TUDORWATCH.COM

