

TUDOR GRANTOUR



TUDOR





1. *Introduction*

2. *Methodology*

3. *Results*

4. *Discussion*

5. *Conclusion*

6. *References*

7. *Appendix*

8. *Index*

9. *Glossary*

10. *Notes*

11. *Footnotes*

12. *Endnotes*

13. *Supplementary Material*

14. *Tables*

15. *Figures*

16. *Tables of Contents*

17. *Table of Figures*

18. *Table of Tables*

19. *Table of Figures*

20. *Table of Tables*

21. *Table of Figures*

22. *Table of Tables*

23. *Table of Figures*

24. *Table of Tables*

25. *Table of Figures*

26. *Table of Tables*

27. *Table of Figures*

28. *Table of Tables*

29. *Table of Figures*

30. *Table of Tables*

31. *Table of Figures*

32. *Table of Tables*

33. *Table of Figures*

34. *Table of Tables*

35. *Table of Figures*

36. *Table of Tables*

37. *Table of Figures*

38. *Table of Tables*

39. *Table of Figures*

40. *Table of Tables*

41. *Table of Figures*

42. *Table of Tables*

43. *Table of Figures*

44. *Table of Tables*

45. *Table of Figures*

46. *Table of Tables*

47. *Table of Figures*

48. *Table of Tables*

49. *Table of Figures*

50. *Table of Tables*

51. *Table of Figures*

52. *Table of Tables*

53. *Table of Figures*

54. *Table of Tables*

55. *Table of Figures*

56. *Table of Tables*

57. *Table of Figures*

58. *Table of Tables*

59. *Table of Figures*

60. *Table of Tables*

61. *Table of Figures*

62. *Table of Tables*

63. *Table of Figures*

64. *Table of Tables*

65. *Table of Figures*

66. *Table of Tables*

67. *Table of Figures*

68. *Table of Tables*

69. *Table of Figures*

70. *Table of Tables*

71. *Table of Figures*

72. *Table of Tables*

73. *Table of Figures*

74. *Table of Tables*

75. *Table of Figures*

76. *Table of Tables*

77. *Table of Figures*

78. *Table of Tables*

79. *Table of Figures*

80. *Table of Tables*

81. *Table of Figures*

82. *Table of Tables*

83. *Table of Figures*

84. *Table of Tables*

85. *Table of Figures*

86. *Table of Tables*

87. *Table of Figures*

88. *Table of Tables*

89. *Table of Figures*

90. *Table of Tables*

91. *Table of Figures*

92. *Table of Tables*

93. *Table of Figures*

94. *Table of Tables*

95. *Table of Figures*

96. *Table of Tables*

97. *Table of Figures*

98. *Table of Tables*

99. *Table of Figures*

100. *Table of Tables*



TUDOR

TUDOR GRANTOUR

CONTENTS

GENERAL INFORMATION	5
WATERPROOFNESS	7
BASIC FUNCTIONS	8
CHRONO FLY-BACK	14
CHRONO	20
DATE	30
MAINTENANCE & GUARANTEE	32
WORLDWIDE SERVICE NETWORK	34





All TUDOR models bear the Swiss Made quality label.

They are equipped with a self-winding mechanical movement, and feature with a synthetic sapphire crystal and a screw down winding crown, to ensure perfect waterproofness.

To ensure that your TUDOR watch remains in perfect working order for many years, please read this document carefully.



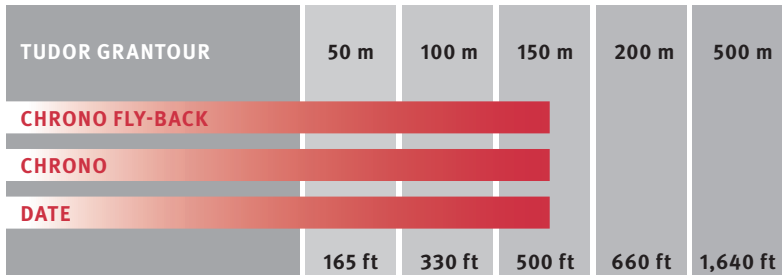

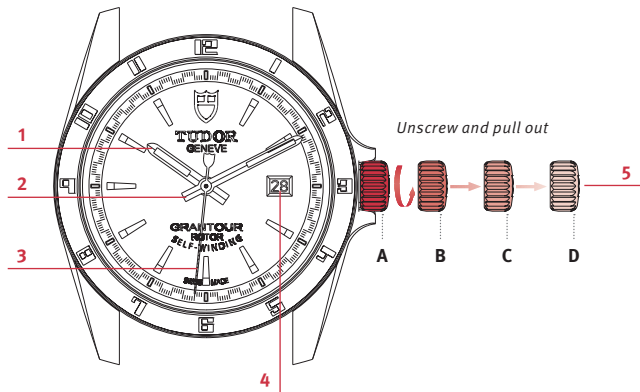



Key

1. Hour hand
2. Minute hand
3. Seconds hand
4. Date window
5. Winding crown

Winding crown

- A. Screwed down position
- B. Manual winding
- C. Date-setting
- D. Time-setting

**SCREWED DOWN POSITION [position A]**

Your TUDOR watch is equipped with a screw-down crown.

Once this is fully screwed down against the case, your watch is guaranteed waterproof.

MANUAL WINDING [position B]

A watch equipped with a self-winding mechanical movement is wound automatically by wrist movements alone. To ensure optimum winding, wear your watch every day.



Before your watch's first use or after it has stopped, you will need to wind it manually by unscrewing the crown and turning it clockwise; the other direction is inactive. After performing the operation, gently press in the crown while turning it gradually clockwise, and screw it down carefully against the case in order to preserve your watch's waterproofness.

Once it has been wound, your Grantour Date has a power reserve of approximately 38 hours. The Grantour Chrono model has a power reserve of approximately 46 hours, and the Grantour Chrono Fly-Back model a power reserve of approximately 42 hours.



DATE-SETTING

ON GRANTOUR CHRONO FLY-BACK AND DATE MODELS [position C]

In order to adjust the date, unscrew the crown and pull it out to the second notch. Then turn it clockwise on your Grantour Date, or anticlockwise on your Grantour Chrono Fly-Back, until the desired date appears in the window. The date is corrected when the hands pass midnight. During this operation, your watch will keep running.

You are recommended not to correct the date between 20:00 and 02:00. If the date is corrected between these times, the date will not change at midnight, but 24 hours later.

For the date-setting on the Grantour Chrono model, refer to the “TUDOR GRANTOUR CHRONO” section on page 27.



TIME-SETTING [position D*]

In order to adjust the time, unscrew the crown and pull it out to the last notch. Then turn it in either direction until the hands indicate the correct time. The seconds hand is stopped during this operation. To synchronise the seconds hand and minute hand, the fine adjustment must be made anticlockwise.

If the watch has stopped, take care not to confuse midday and midnight during this operation. Move the hands forward to 12 o'clock; if the date changes, then it is midnight.

After each operation, remember to push the crown back in and screw it back down carefully against the case, in order to preserve your watch's waterproofness.

* in position C on your Grantour Chrono.



DISPLAY

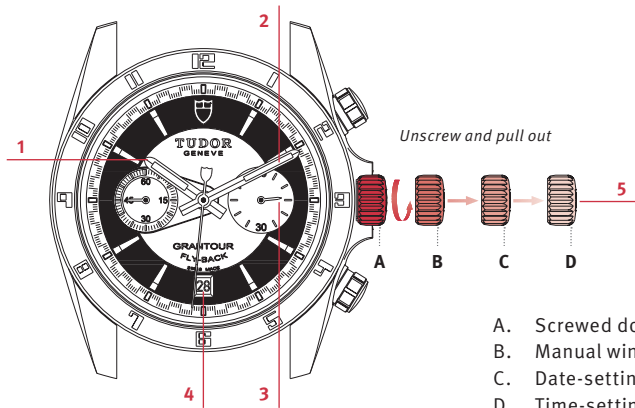

- A. Screwed down position
- B. Manual winding
- C. Date-setting
- D. Time-setting



Ø 42 mm, TUDOR calibre 2892 with an additional module for the Fly-Back function, waterproof to 150 metres (500 feet).
60-minute chronograph, date (date window), small seconds hand, black-lacquered steel bezel, crown guard, bistable pushers.

Key

1. Hour hand
2. Minute hand
3. Small seconds hand
4. Date window
5. Winding crown



CHRONOGRAPH DISPLAY

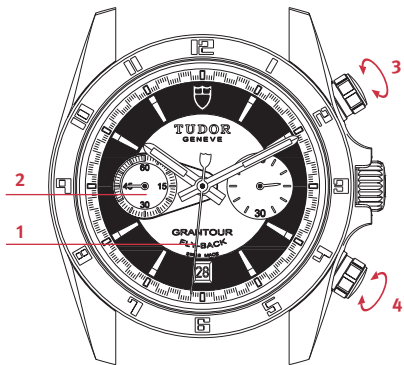



Key

1. Centre seconds hand (chronograph seconds hand)
2. 60-minute counter (chronograph minute hand)
3. Chronograph start/stop bistable pusher
4. Chronograph reset & instant restart bistable pusher



CHRONOGRAPH FUNCTION

The chronograph function enables you to measure times to fractions of a second, thanks to the centre seconds hand. To measure longer intervals, this chronograph has a 60-minute counter.

Pressing the start/stop pusher a first time will start the chronograph. Pressing it again will stop the chronograph, and pressing a third time will start it again. In this way you can measure several times in succession.

To reset all the chronograph counters, press the reset pusher; the chronograph will be ready for use again. Resetting is only possible when the chronograph has stopped.

To be enabled for use, the start/stop and reset pushers must be unlocked by turning them through a 1/8th rotation; lock the pushers after use.



FLY-BACK FUNCTION

The Fly-Back function enables you to start a new timing operation with the chronograph already running. To do so you need only press the reset pusher, without first having to stop the hands using the start/stop pusher. When you press the reset pusher, your chronograph will restart a new timing operation.

To be enabled for use, the start/stop and reset pushers must be unlocked by turning them through a 1/8th rotation; lock the pushers after use.

For other adjustments to your watch, refer to the “BASIC FUNCTIONS” section on page 8.



DISPLAY

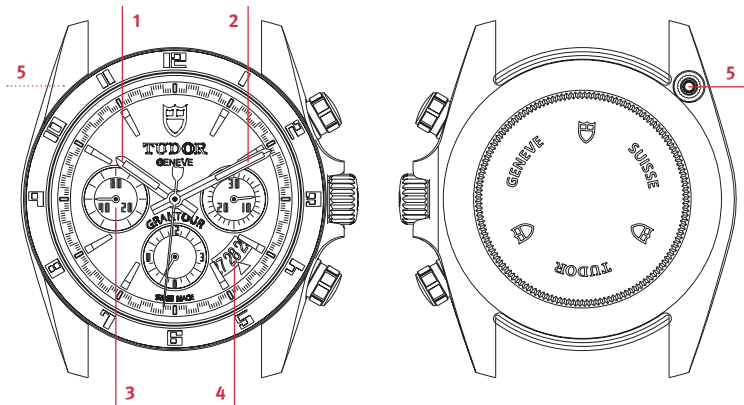



Ø42 mm, TUDOR calibre 7753, waterproof to 150 metres (500 feet).
12-hour chronograph, date (date window), small seconds hand,
black-lacquered steel bezel, crown guard, bistable pushers.

Key

1. Hour hand
2. Minute hand
3. Small seconds hand
4. Date window
5. Date corrector (under lug)



CHRONOGRAPH DISPLAY

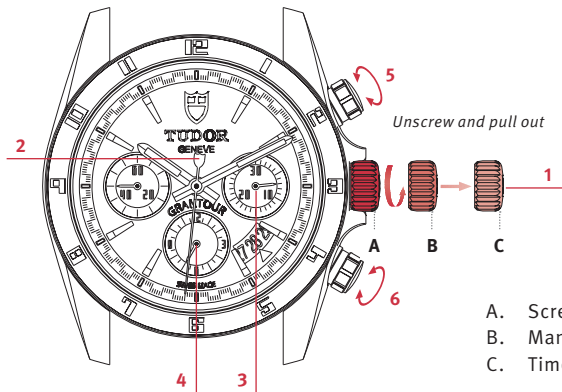

- A. Screwed down position
- B. Manual winding
- C. Time-setting



Key

1. Winding crown
2. Centre seconds hand (chronograph seconds hand)
3. 30-minute counter (chronograph minute hand)
4. 12-hour counter (chronograph hour hand)
5. Chronograph start/stop bistable pusher
6. Chronograph reset bistable pusher



CHRONOGRAPH FUNCTION

The chronograph function enables you to measure times to fractions of a second, thanks to the centre seconds hand. To measure longer intervals, this chronograph has two additional 30-minute and 12-hour counters.

Pressing the start/stop pusher a first time will start the chronograph. Pressing it again will stop the chronograph, and pressing a third time will start it again. In this way you can measure several times in succession.

In the example opposite, the measured time readout is as follows:
7 hours, 7 minutes and 31 seconds.



TUDOR GRANTOUR

CHRONO





To reset all the chronograph counters, press the reset pusher; the chronograph will be ready for use again. Resetting is only possible when the chronograph has stopped.

To be enabled for use, the start/stop and reset pushers must be unlocked by turning them through a 1/8th rotation; lock the pushers after use.



DATE-SETTING

In order to adjust the date, you are only recommended to use the TUDOR tool, as in the diagram on page 28. It is supplied with your watch, and enables you to manipulate the date corrector situated under the lug at 10 o'clock.

You can change the date simply by pressing the corrector using the TUDOR tool. The date cannot be changed by means of the crown.

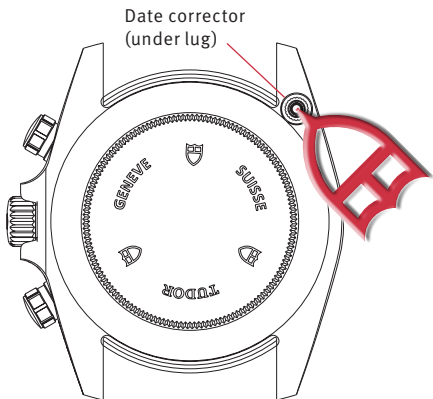



It is essential not to adjust the date between 20:30 and 23:00, to avoid damaging the movement.

For other adjustments to your watch, refer to the “BASIC FUNCTIONS” section on page 8.

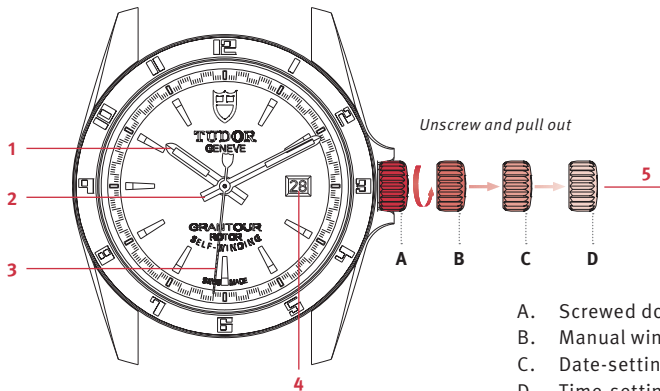

- A. Screwed down position
- B. Manual winding
- C. Date-setting
- D. Time-setting



Ø 42 mm, TUDOR calibre 2824, waterproof to 150 metres (500 feet).
Date (date window), black-lacquered steel bezel, crown guard.

Key

1. Hour hand
2. Minute hand
3. Seconds hand
4. Date window
5. Winding crown

For other adjustments to your watch, refer to the “BASIC FUNCTIONS” section on page 8.



Thanks to TUDOR's expertise, your watch will require very little day-to-day care.

However, you can maintain the shine on your watch and its metal bracelet using a microfibre cloth. You can also wash it from time to time, using a soft brush and soapy water.

Before performing these operations, check that the crown is properly screwed down against the case, in order to guarantee your watch's waterproofness.

To help conserve your leather or fabric strap, we recommend protecting it from water and moisture.



Your TUDOR watch is covered by a 2-year international guarantee.

The guarantee card that accompanies your watch must be properly completed, signed and dated by the Official TUDOR Retailer at the time of purchase.

The guarantee does not cover normal wear of components, or damage caused by accident or mishandling, or the loss or theft of your watch.

Any modification of your watch by the addition of non-original parts, or the substitution of parts with non-original parts, will void your guarantee.



TUDOR watches are sold only by Official TUDOR Retailers.

Each TUDOR watch is a complex precision mechanism and, as such, requires periodic servicing and maintenance to guarantee optimum performance.

Expert TUDOR servicing can be carried out via any of the Official Retailers and Service Centres in the extensive ROLEX or TUDOR service network. This worldwide network spans five continents and is staffed by highly skilled watchmakers trained to respond to all your service needs.

Please contact your ROLEX Affiliate for an up-to-date list of TUDOR Official Retailers and Service Centres for your region.

TUDORWATCH.COM







TUDOR

TUDORWATCH.COM

