

«MP-05 *La Ferrari*»
INSTRUCTION MANUAL



MOVEMENT & FUNCTIONS

INTRODUCTION

The movement which powers the MP-05 La Ferrari is unique in its design – inspired by a Ferrari engine – and in its technical refinement with a 50-day power reserve. This is a world record in modern watchmaking. It is fitted with a tourbillon integrated perpendicular to the movement for better appreciation of its truly spectacular inner mechanics.



The tourbillon cage displays the seconds counting down while, to the left and right of the movement, there are 2 engraved anodised aluminium cylinders displaying the “hours and minutes” on the one side and the movement’s “power reserve” on the other. Just the bare essentials.



SETTING THE TIME

INTRODUCTION

This function enables the time to be set via the crown on the back of the watch, using a removable tool (screwed onto the key ring supplied in the case).

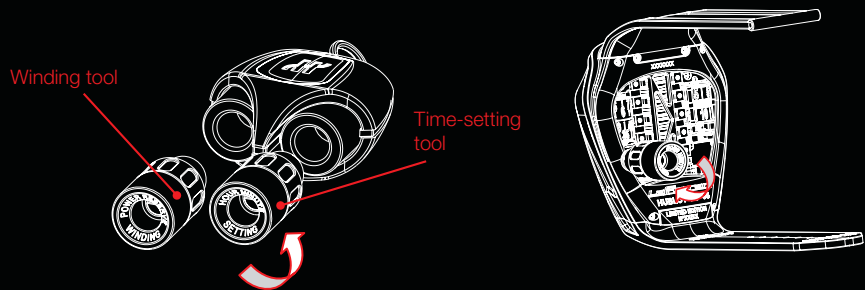

1. Unscrew the time-setting tool from your key ring
2. Turn your watch over and place your tool on the crown of the watch
3. Turn the crown clockwise to set the watch to the desired time.

NB: Whenever setting the time, you need to compensate for the movement's functional gear play; which is 2 minutes. So to allow for this difference, you need to set the time 2 minutes ahead.

4. Remove the tool and screw it back onto the key ring for safekeeping

WINDING

INTRODUCTION

This function enables your watch to accumulate the energy required to run properly.

PRECAUTION FOR USE

This watch is designed to run for approximately 50 days, i.e. approximately 1200 hours. After this period, you must wind your watch to provide it with the energy necessary to run properly.

The power reserve indicator may pass the maximum level (corresponding to the number 50 on the left-hand cylinder). This depends on the movement which has a power reserve which may exceed 50 days.



PROCEDURE

When the power reserve indicator is close to zero, you must wind your watch. To do this, you must turn the crown on the back of the watch clockwise – as shown in the figure opposite.

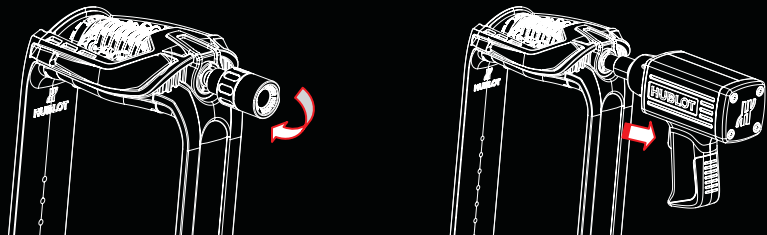

You can use 2 tools to do this:

1. The manual tool screwed onto the key ring, which is handy for making minor adjustments to the power reserve when you are out and about.

2. The self-winding pistol, used to quickly and easily wind the watch fully to restore the 50-day power reserve.



DISASSEMBLING AND REASSEMBLY THE WATCHSTRAP

REMOVING AND REFITTING THE WATCH STRAP



- Remove the 2 bracelet screws using the tool ref. MSA01.108-1.5



- Slide the strand down to detach it from the case

REMOVING THE 12 O'CLOCK STRAND



- Remove the 2 bracelet screws using the tool ref. MSA01.108-1.2

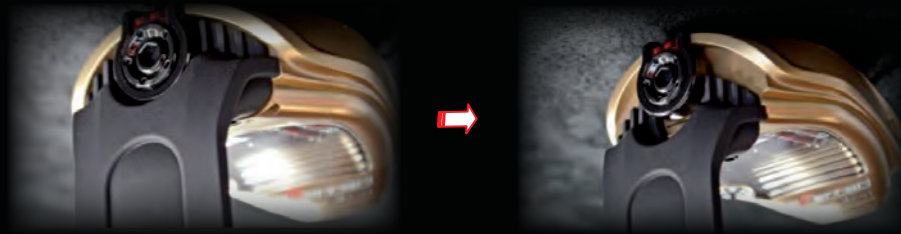

- Slide the strand down to detach it from the case

REMOVED BRACELET STRANDS

REMOVED STRAP STRANDS



CASE & ACCESSORIES

The case comprises several storage compartments:

- Lower section of the case: this contains a drawer which opens manually, used for storing the key ring and the self-winding tool.
- Upper section: this is the area used to store your watch, accessed by gently pressing a touch button on the side which automatically opens and closes the case.

The case can be used while connected to the mains supply, or disconnected from the power supply if it has already been charged (charging for 2 hours enables approximately 20 opening/closing operations).

The self-winding pistol enables the watch to be wound several times. It must be recharged using its USB cable.

PRECAUTION FOR USE

When you first use the case, to unlock it, you should:

1. Press the side button for 3-5 seconds, then release.
2. Press the button again for one second, the button will light up and the case will open automatically.

For information, after 10 minutes without use, the case will lock automatically.

To unlock, repeat steps 1 and 2 above.



INSTRUCTION MANUAL

WARRANTY

The card at the end of your Hublot kit is an electronic warranty certificate, which contains your watch's identity code, and also grants you privileged access to the Hublotista area available on the Hublot website (www.hublot.com). The card must be activated electronically, or completed and the Hublot stamp applied.

Each Hublot watch bears an individual identification number, which proves its authenticity. Your Hublot watch is guaranteed against all manufacturing defects for a period of two years from the date of purchase, provided that the watch was purchased from an approved Hublot retailer. However, this warranty does not cover damage caused by inappropriate use or handling of the watch.

For any repair during the warranty period, please enclose with the watch the pre-activated warranty card signed by an approved Hublot retailer, an exhaustive list of which can be found on our website.

Should the watch require any kind of servicing, please contact an approved Hublot retailer or After-Sales service centre only, the contact details of which can be found on the Hublot website.

All repairs or servicing work carried out by third parties not authorised by Hublot will automatically invalidate your warranty; in which case any damage would be rectified at your expense.

