

TUDOR HERITAGE CHRONO

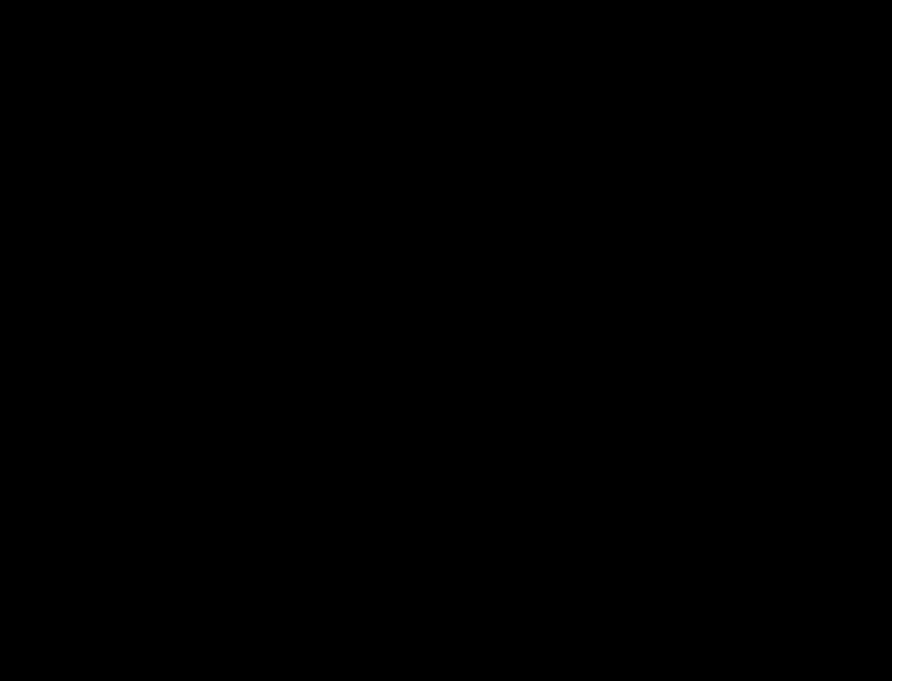

TUDOR







TUDOR

TUDOR HERITAGE CHRONO

CONTENTS

GENERAL INFORMATION	5
WATERPROOFNESS	7
CHRONO	8
MAINTENANCE & GUARANTEE	26
WORLDWIDE SERVICE NETWORK	28





All TUDOR models bear the Swiss Made quality label.

They are equipped with a self-winding mechanical movement, and feature a synthetic sapphire crystal and a screw-down winding crown, to ensure perfect waterproofness.

To ensure that your TUDOR watch remains in perfect working order for many years, please read this document carefully.





TUDOR HERITAGE

WATERPROOFNESS

TUDOR HERITAGE	50 m	100 m	150 m	200 m	500 m
CHRONO					
	165 ft	330 ft	500 ft	660 ft	1,640 ft



DISPLAY

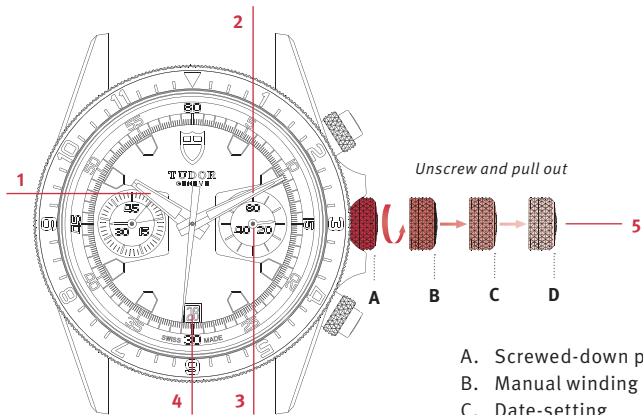

- A. Screwed-down position
- B. Manual winding
- C. Date-setting
- D. Time-setting



Ø 42 mm, TUDOR calibre 2892 with additional mechanism for the chronograph function, waterproof to 150 metres (500 feet). 45-minute chronograph, date (window-type display), small seconds hand, 12-hour graduated bidirectional rotatable bezel for second time-zone display, crown guard, screw-down pushers.

Key

1. Hour hand
2. Minute hand
3. Small seconds hand
4. Date window
5. Winding crown



SCREWED-DOWN POSITION [position A]

Your TUDOR watch is equipped with a screw-down crown. Once this is fully screwed down against the case, your watch is guaranteed waterproof.

MANUAL WINDING [position B]

A watch equipped with a self-winding mechanical movement is wound automatically by wrist movements alone. To ensure optimum winding, wear your watch daily.



Before you first use the watch or if it has stopped, you will need to wind it manually by unscrewing the crown and turning it clockwise; the other direction is inactive. After performing the operation, gently press in the crown while turning it gradually clockwise, and screw it down carefully against the case in order to preserve your watch's waterproofness.

Once wound, and without being worn, the Tudor Heritage Chrono has a power reserve of approximately 42 hours.



DATE-SETTING [position C]

In order to adjust the date, unscrew the crown and pull it out to the second notch. Then turn it anticlockwise until the desired date appears in the window. The date is adjusted when the hands pass midnight. During this operation, your watch will keep running.

You are advised not to correct the date between 20:00 and 02:00. If the date is corrected between these times, the date will not change at midnight, but 24 hours later.



TIME-SETTING [position D]

In order to adjust the time, unscrew the crown and pull it out to the last notch. Then turn it in either direction until the hands indicate the correct time. The small seconds hand is stopped during this operation. To synchronize the small seconds hand and minute hand, the fine adjustment must be performed in an anticlockwise direction.

If the watch has stopped, take care not to confuse midday and midnight during this operation. Move the hands forward to 12 o'clock; if the date changes, then it is midnight.

After each operation, remember to push the crown back in and screw it back down carefully against the case, in order to preserve your watch's waterproofness.



CHRONOGRAPH DISPLAY

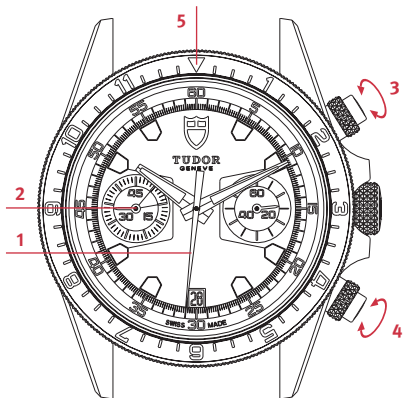



Key

1. Centre seconds hand (chronograph seconds hand)
2. 45-minute counter (chronograph minute hand)
3. Chronograph start/stop pusher
4. Chronograph reset pusher
5. Bidirectional rotatable bezel



CHRONOGRAPH FUNCTION

The chronograph function enables you to measure times to fractions of a second, thanks to the centre seconds hand. To measure longer intervals, this chronograph has an additional 45-minute counter.

Pressing the start/stop pusher a first time will start the chronograph. Pressing it again will stop the chronograph, and pressing a third time will start it again. In this way you can measure several times in succession.

To reset the chronograph counter, press the reset pusher; the chronograph will be ready for use again. Resetting is only possible when the chronograph has stopped.

To be enabled for use, the start/stop and reset pushers must be unscrewed; lock the pushers after use.



SECOND TIME-ZONE FUNCTION

The second time-zone function is used to display two time zones simultaneously.

The time of the second time zone is read by means of the hour hand, the minute hand and the bidirectional rotatable bezel. Simply turn the bezel clockwise or anticlockwise depending on the desired time zone.

When you move westward, for example from Geneva to Mexico, turn the bezel clockwise, then turn anticlockwise when you move eastward, for example from Geneva to Tokyo. The triangle engraved on the bezel serves as a benchmark; in neutral position, it stands at 12 o'clock.

**EXAMPLE: GENEVA › MEXICO**

In the example on the following page, the main time indicated on the dial, 10:10, corresponds to Geneva. Mexico, your second time zone, has a negative time of 7 hours from Geneva. To display the time in this city, turn the bezel clockwise and move the triangle by -7 hours from its initial position, at 12 o'clock. The bezel on your watch now shows the local time in Mexico, namely 3:10.

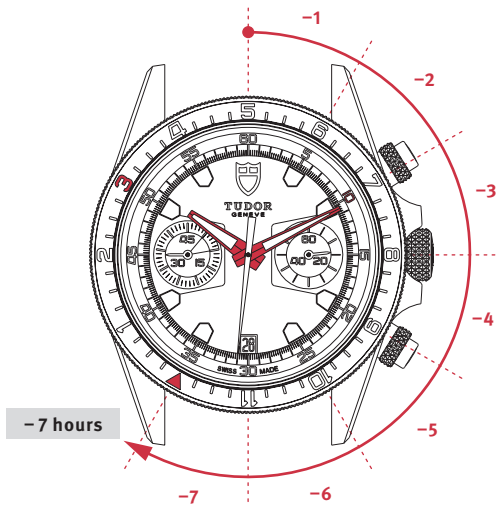

**EXAMPLE: GENEVA › TOKYO**

In the example on the following page, the main time indicated on the dial, 10:10, corresponds to Geneva. Tokyo, your second time zone, has a positive time of 8 hours from Geneva. To display the time in this city, turn the bezel anticlockwise and move the triangle by +8 hours from its initial position, at 12 o'clock. The bezel on your watch now shows the local time in Tokyo, namely 18:10.

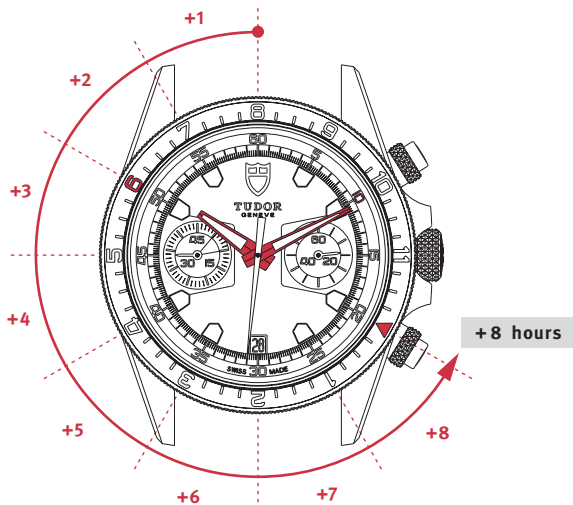



The map below will help you to familiarize yourself with the time zones.

After each operation, remember to push the crown back in and screw it back down carefully against the case, in order to preserve your watch's waterproofness.

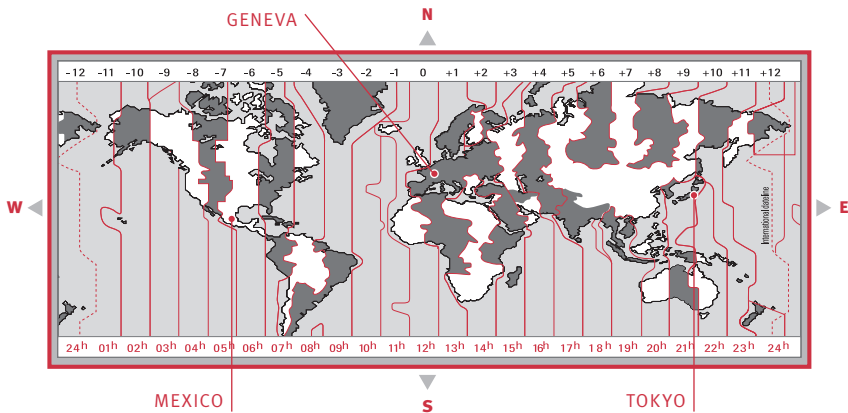



ADJUSTING THE FABRIC STRAP

The Tudor Heritage Chrono model comes with an additional fabric strap. The length of the fabric strap can be adjusted by sliding it through the buckle and loops.

Only TUDOR Official Retailers are authorized to change the watch strap.



Shortening the strap

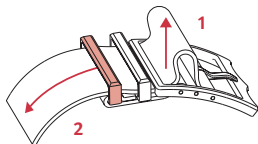
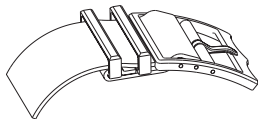

Lengthening the strap

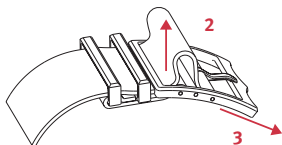
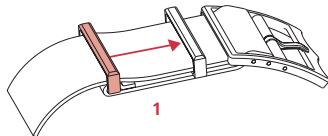



Thanks to TUDOR's expertise, your watch will require very little day-to-day care.

However, you can maintain the shine on your watch and its metal bracelet by using a microfibre cloth. You can also wash it from time to time, using a soft brush and soapy water.

Before performing these operations, check that the crown is properly screwed down against the case, in order to guarantee your watch's waterproofness.

To help conserve your fabric strap, we recommend protecting it from water and moisture.



Your TUDOR watch is covered by a 2-year international guarantee.

The guarantee card that accompanies your watch must be properly completed, signed and dated by the Official TUDOR Retailer at the time of purchase.

The guarantee does not cover normal wear of components, or damage caused by accident or mishandling, or the loss or theft of your watch.

Any modification of your watch by the addition of non-original parts, or the substitution of parts with non-original parts, will void your guarantee.



TUDOR watches are sold only by Official TUDOR Retailers.

Each TUDOR watch is a complex precision mechanism and, as such, requires periodic servicing and maintenance to guarantee optimum performance.

Expert TUDOR servicing can be carried out via any of the Official Retailers and Service Centres in the extensive ROLEX or TUDOR service network. This worldwide network spans five continents and is staffed by highly skilled watchmakers trained to respond to all your service needs.

Please contact your ROLEX Affiliate for an up-to-date list of TUDOR Official Retailers and Service Centres for your region.

TUDORWATCH.COM



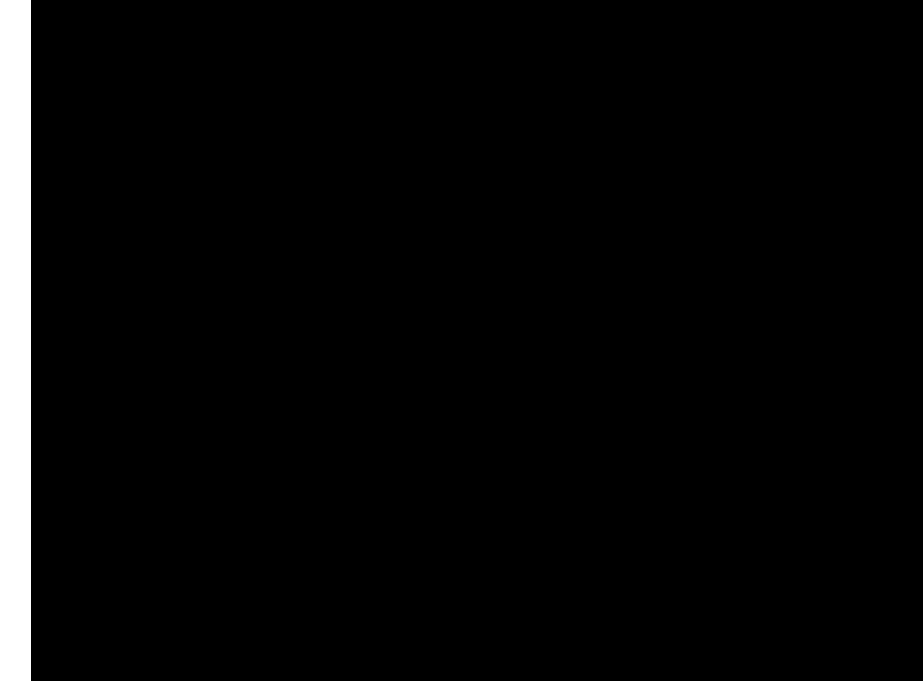



TUDOR

TUDORWATCH.COM

